

固定方式一：
将卡扣穿过对应固定孔，
按对应角度曲折（图一）
Fitting method 1:
put the tab in the slot,
bend properly(p1)

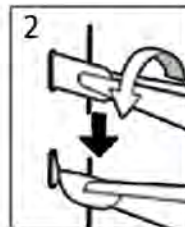

固定方式二：
将卡扣穿过对应固定孔，
用钳子类工具垂直扭曲固
定卡扣（图二）
Fitting method 2:
put the tab in the slot,
bend the tab vertically
with plier(p2).



非纹理面
Non textured surface

注意细节
ATTENTION TO DETAIL

镂空部分
HOLLOW PART

板件上附带编号
Serial number in the sheet

注意拼装前带手指套
Take finger cots before assembly

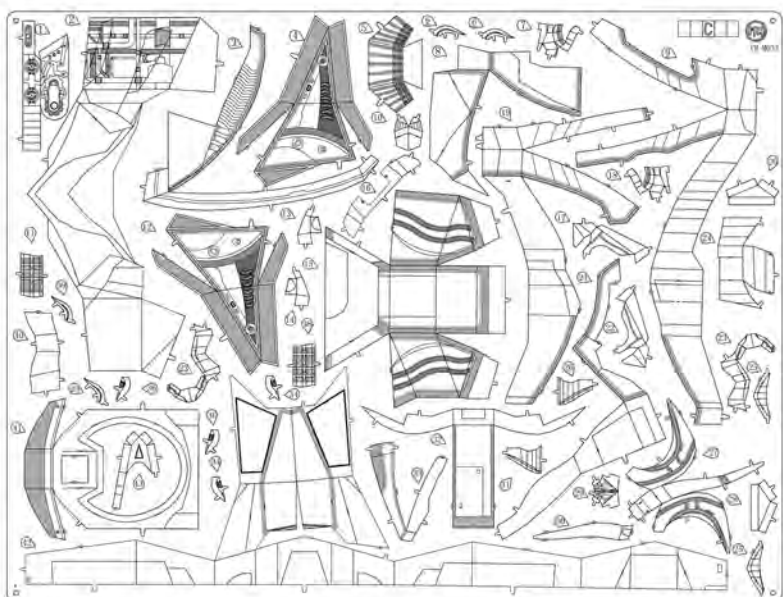
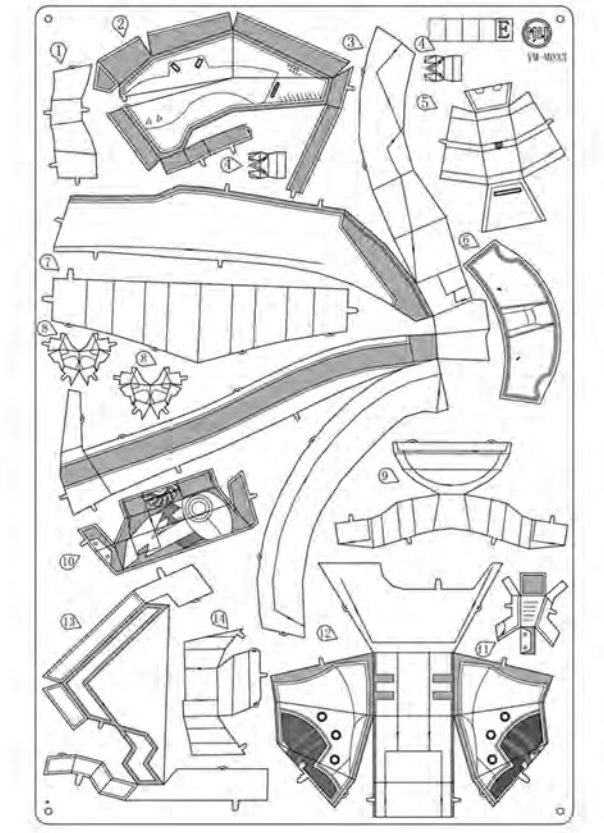
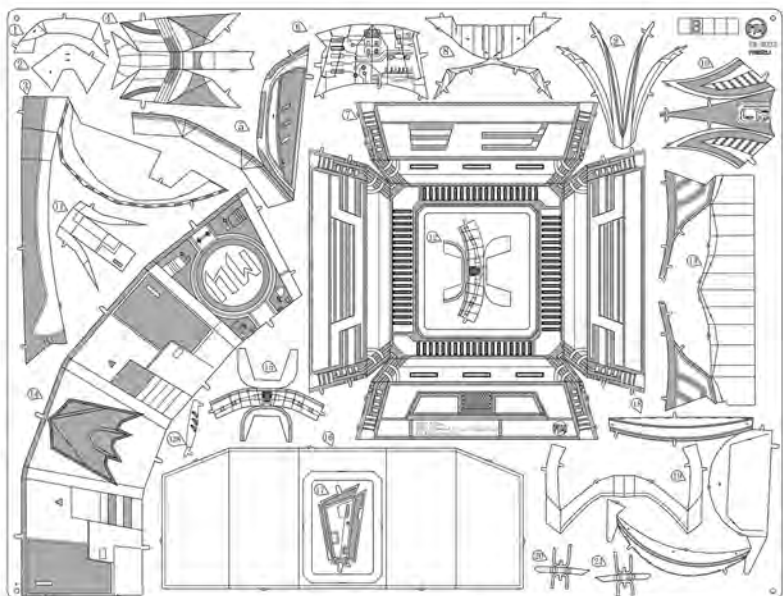
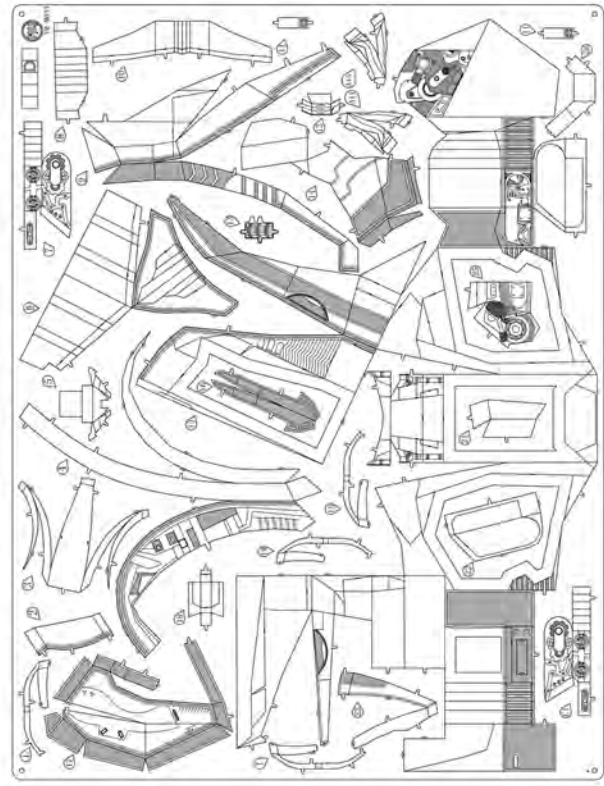
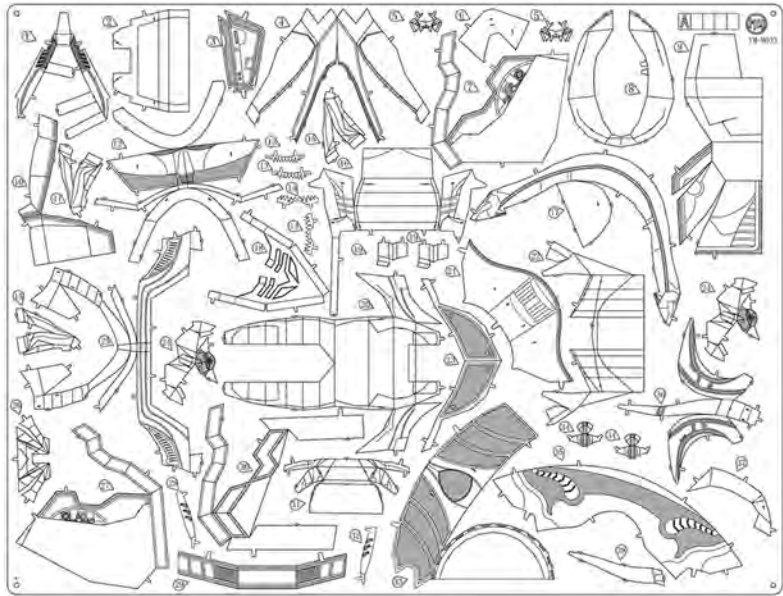

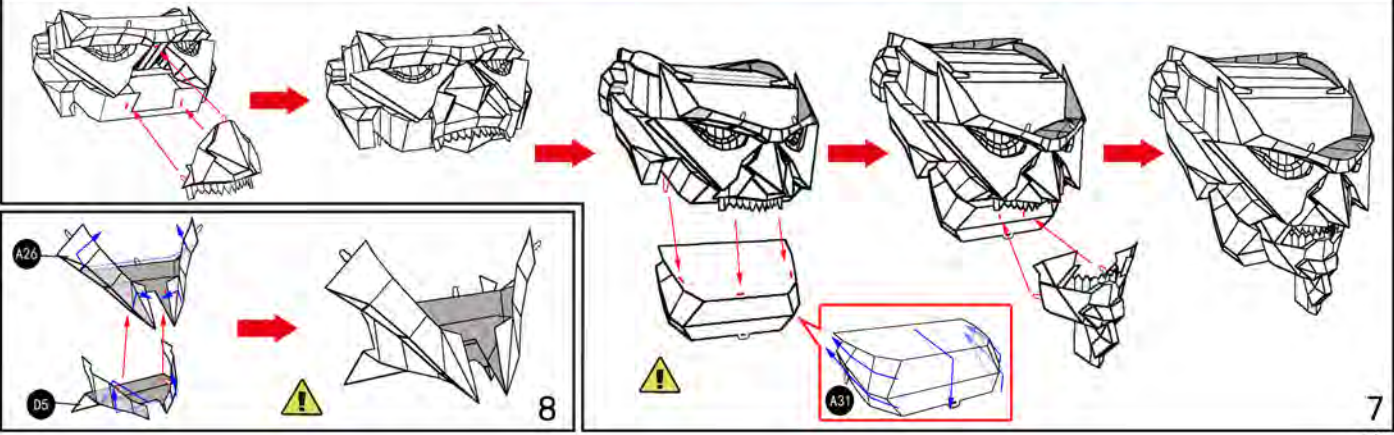
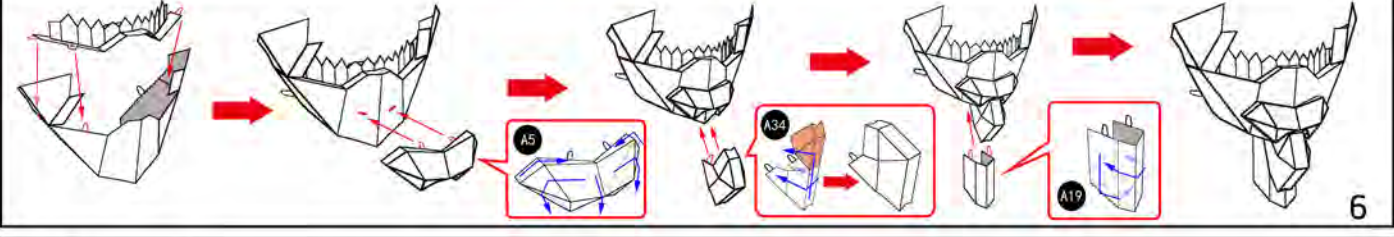
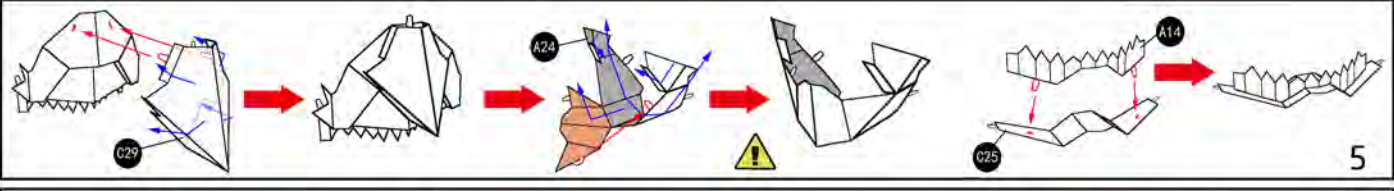
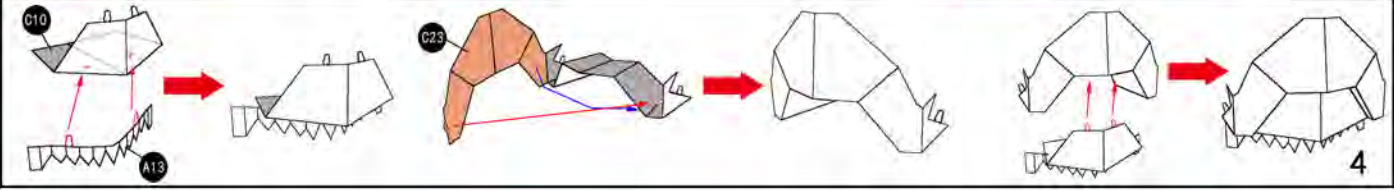
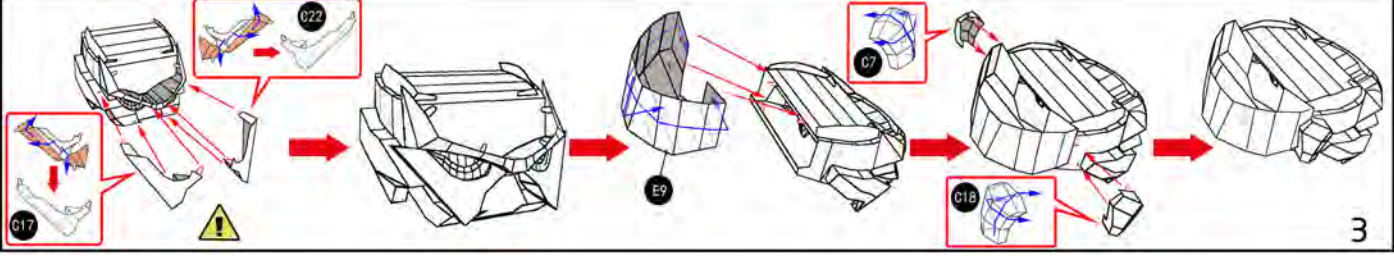
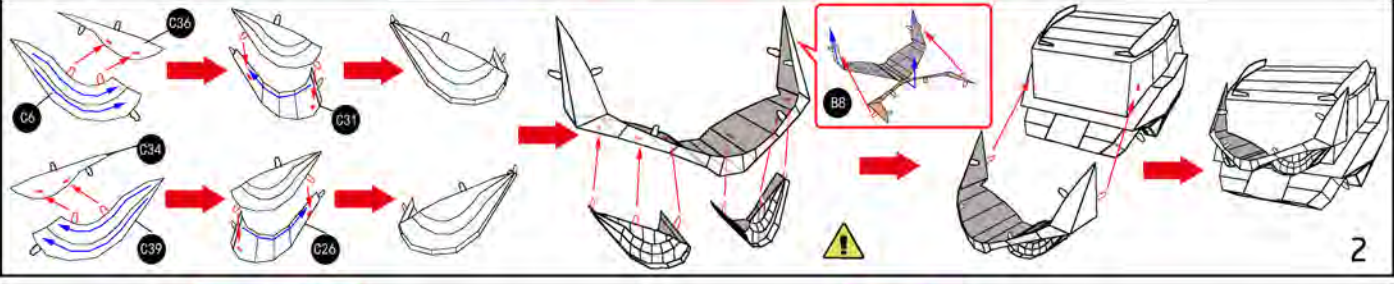
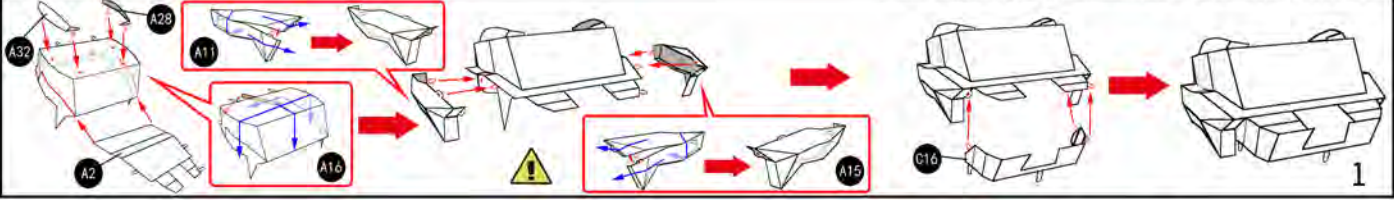

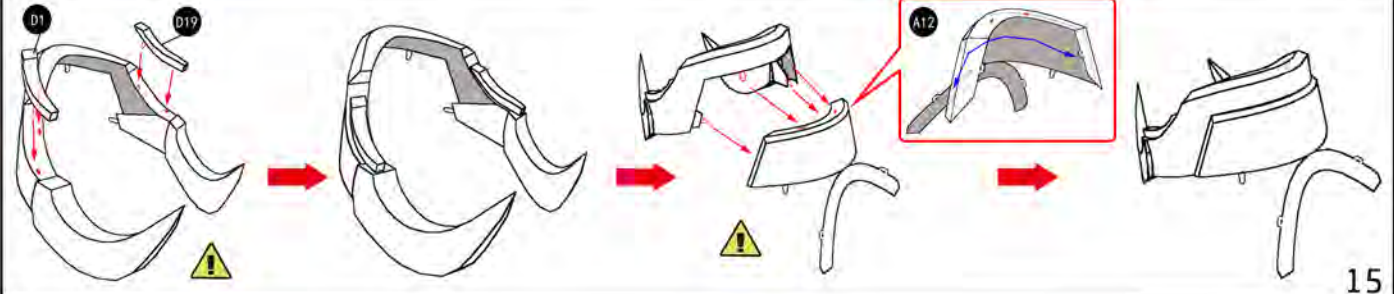
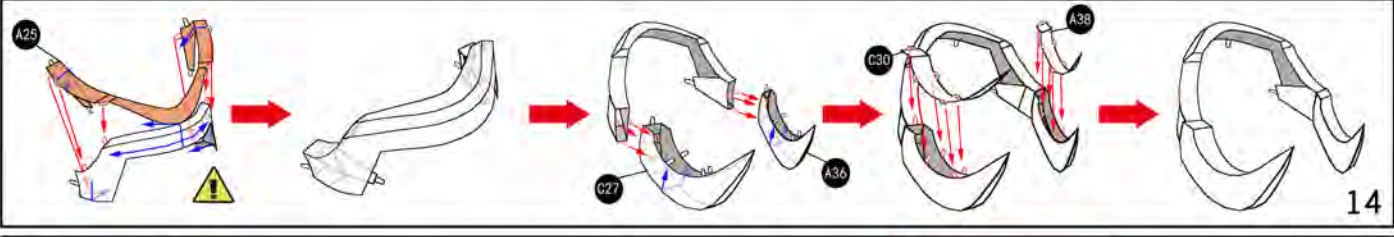
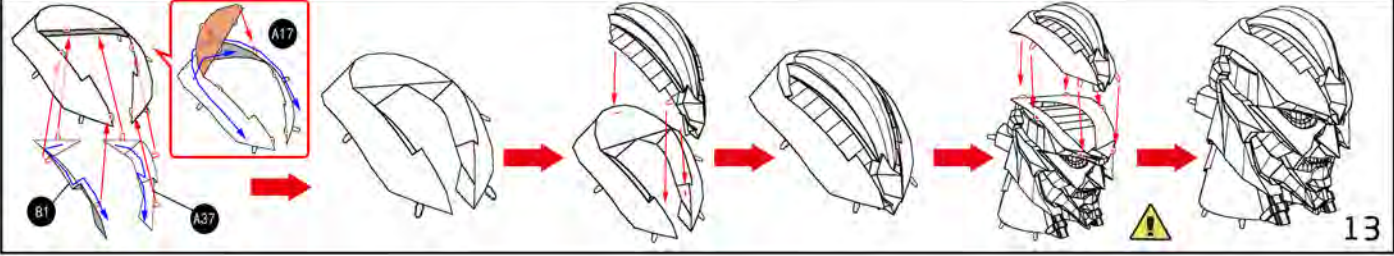
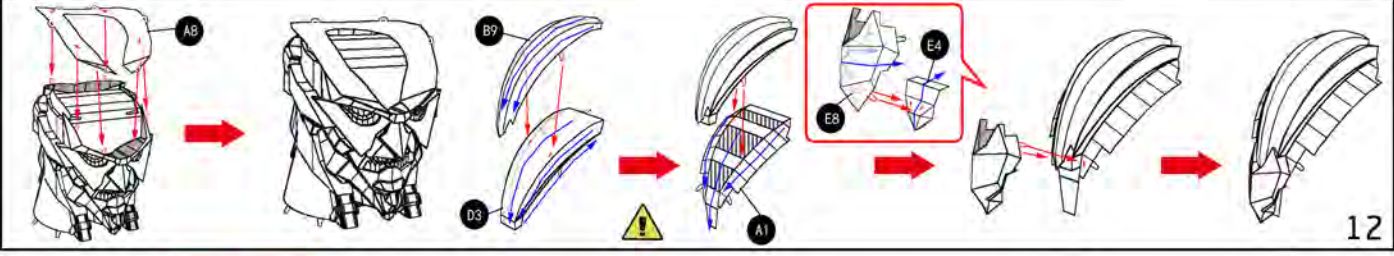
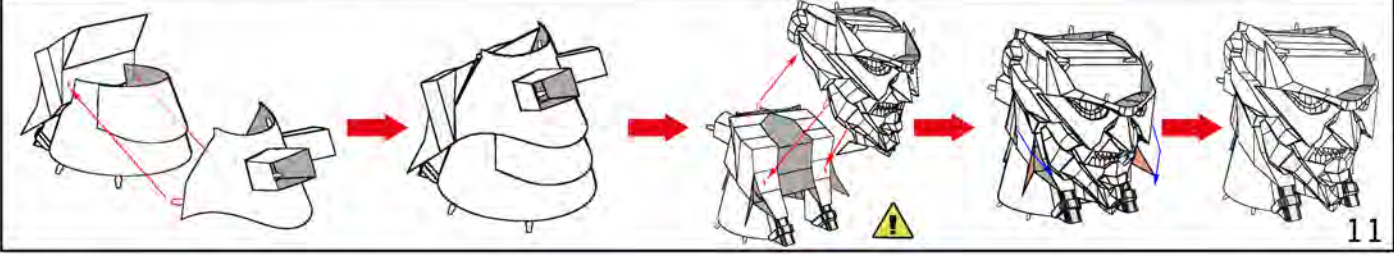
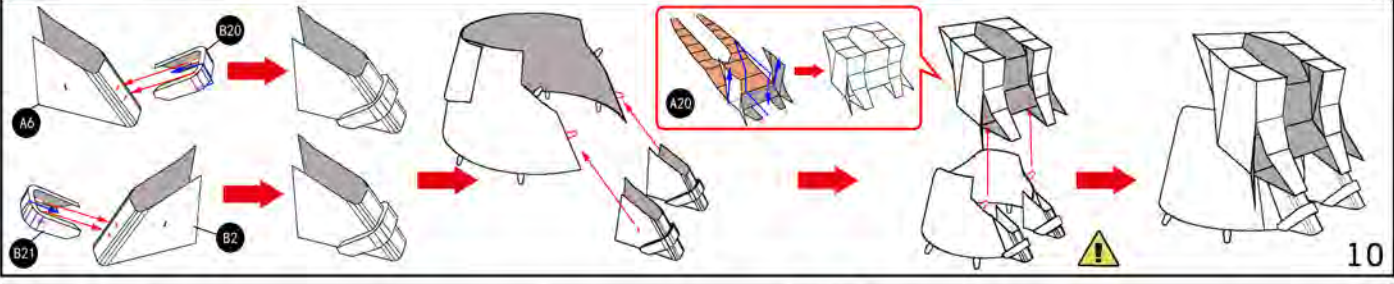
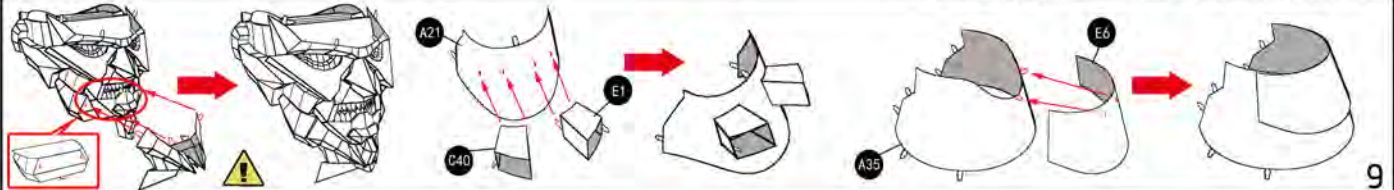

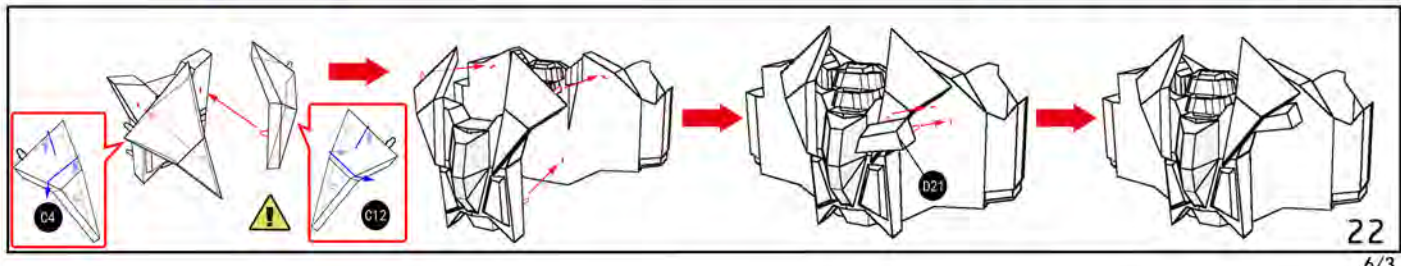
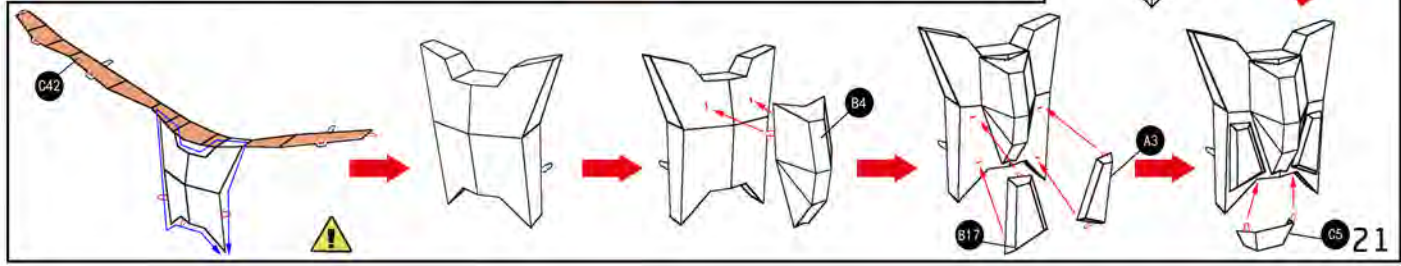
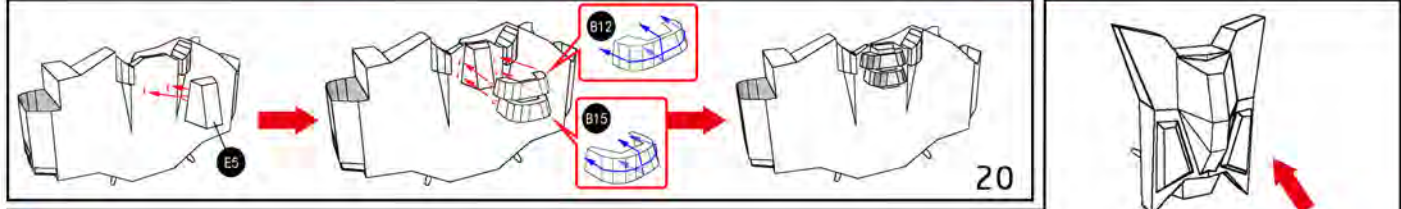
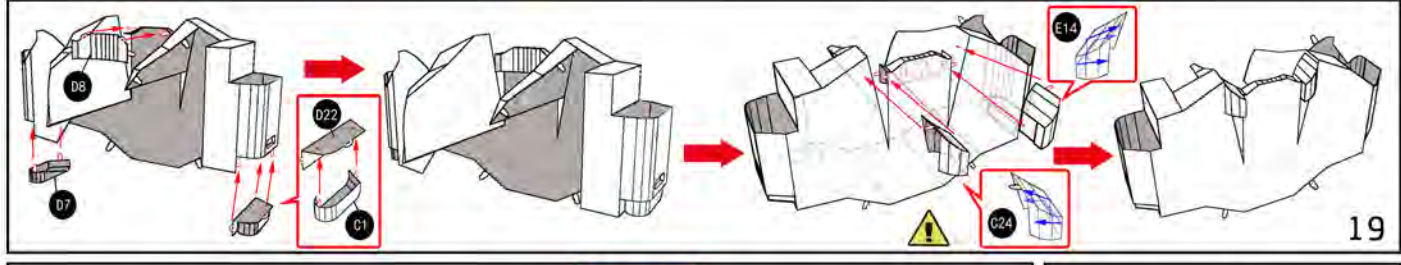
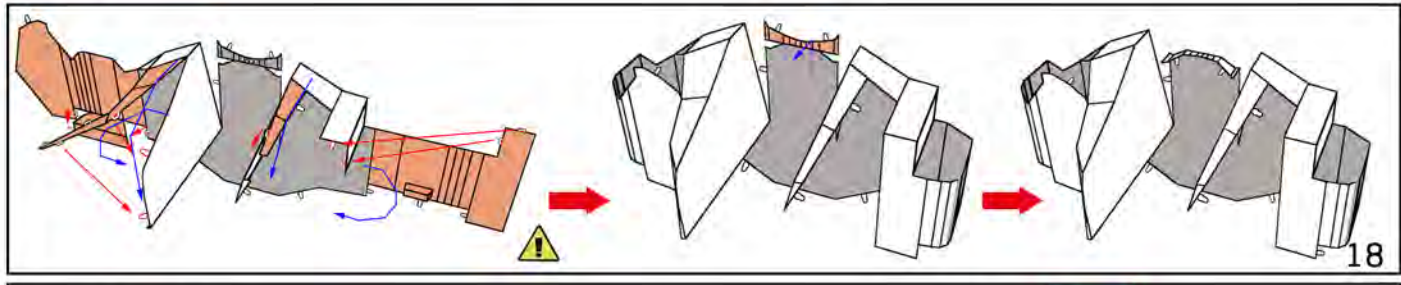
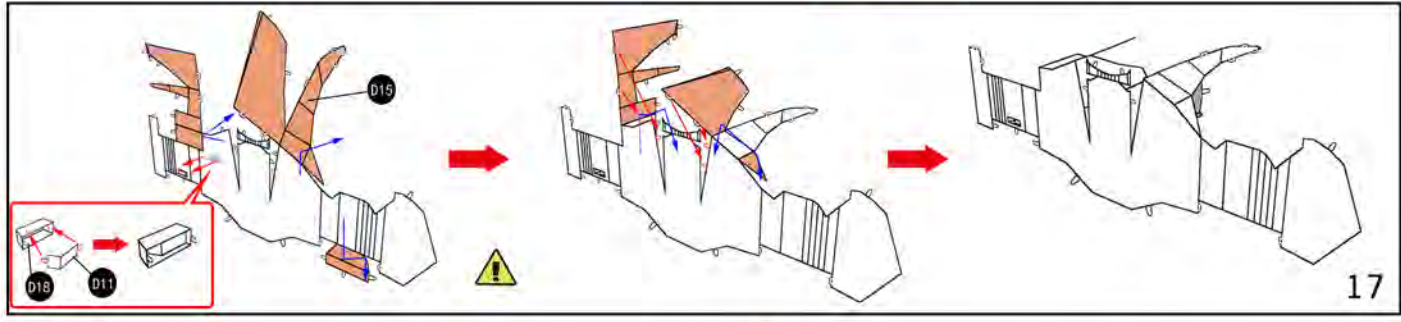
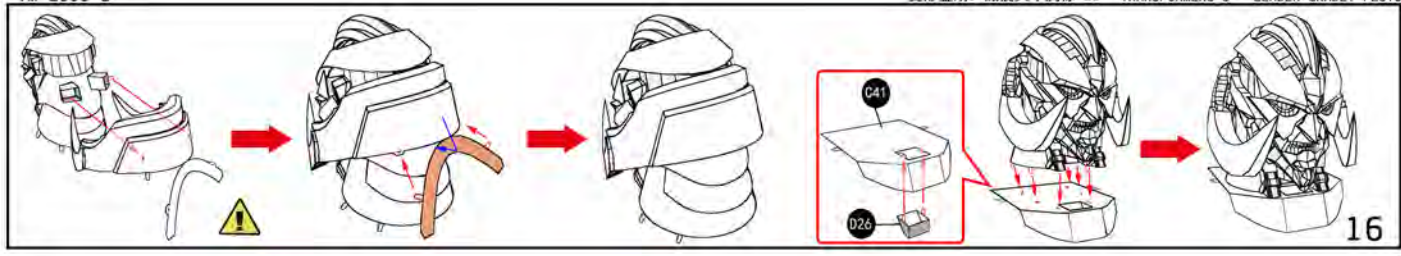

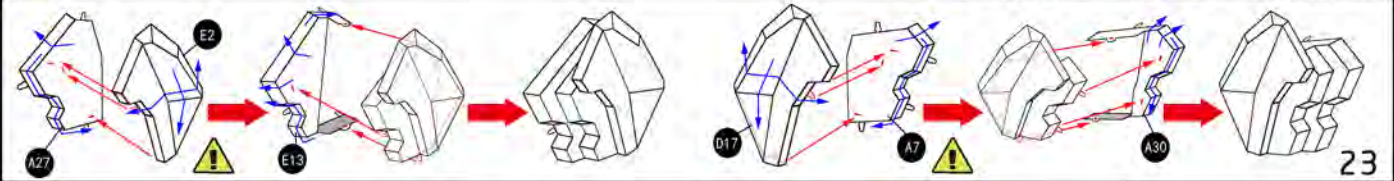

23

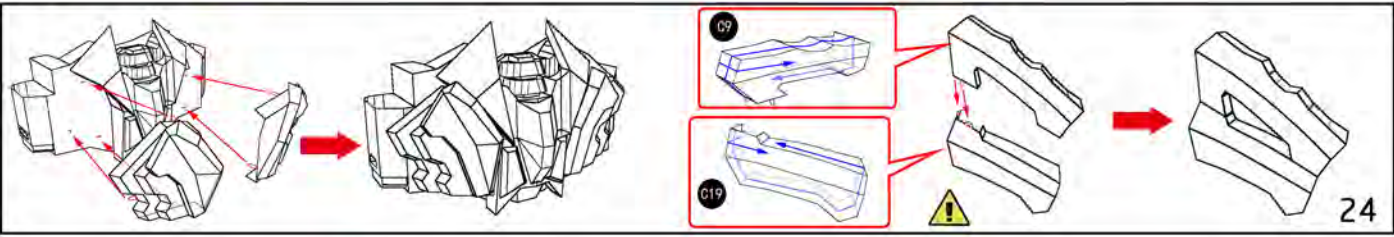

24

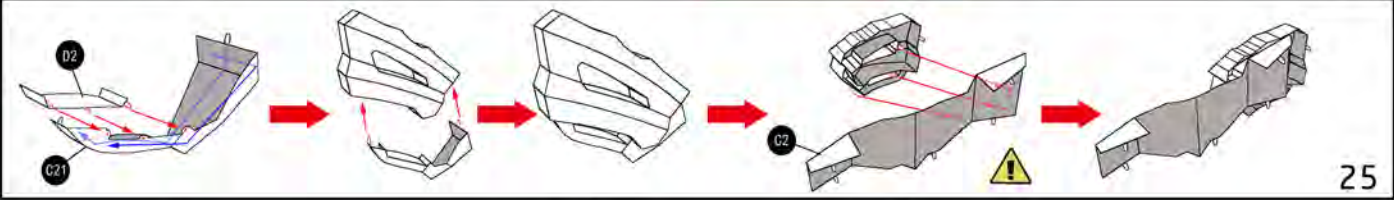

25

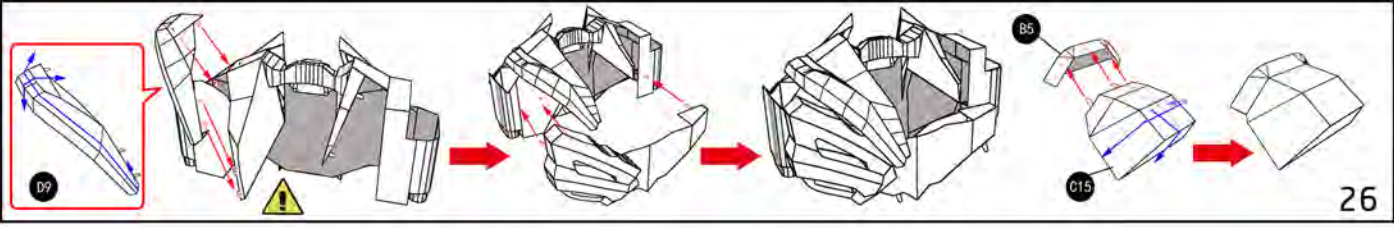

26

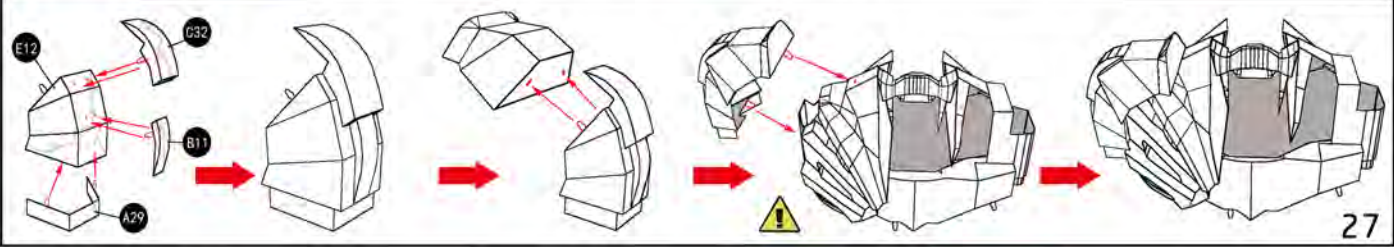

27

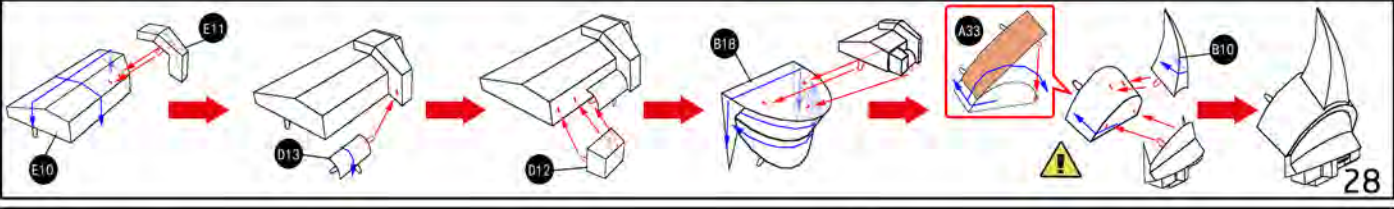

28

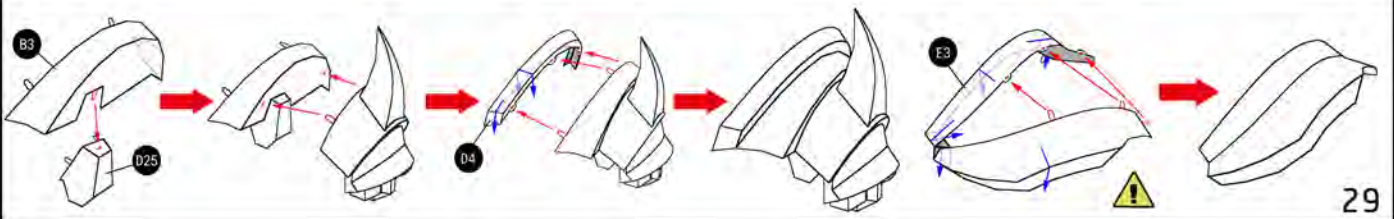

29

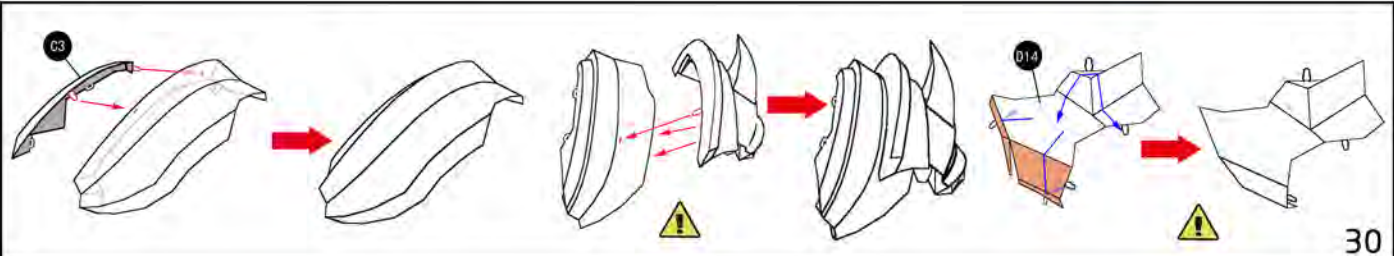

30

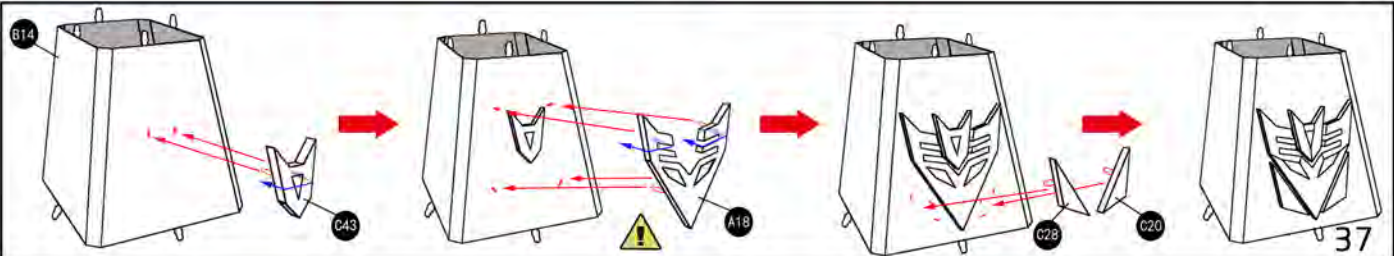
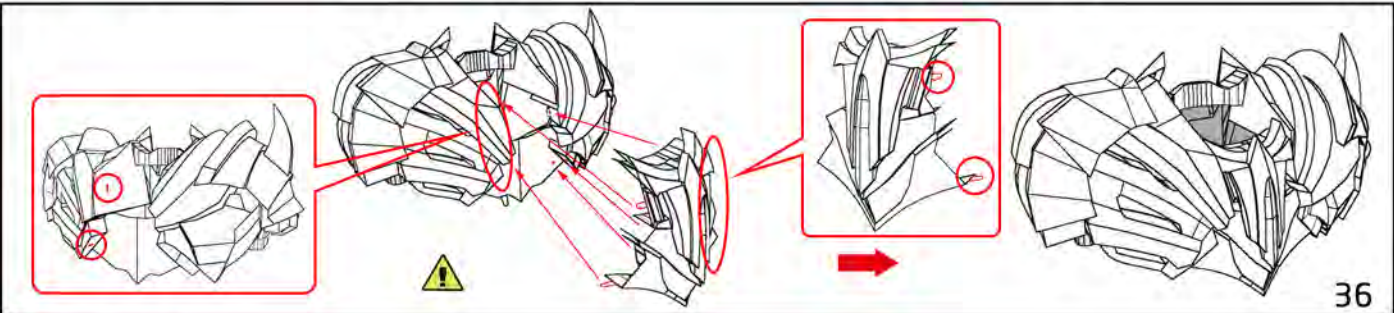
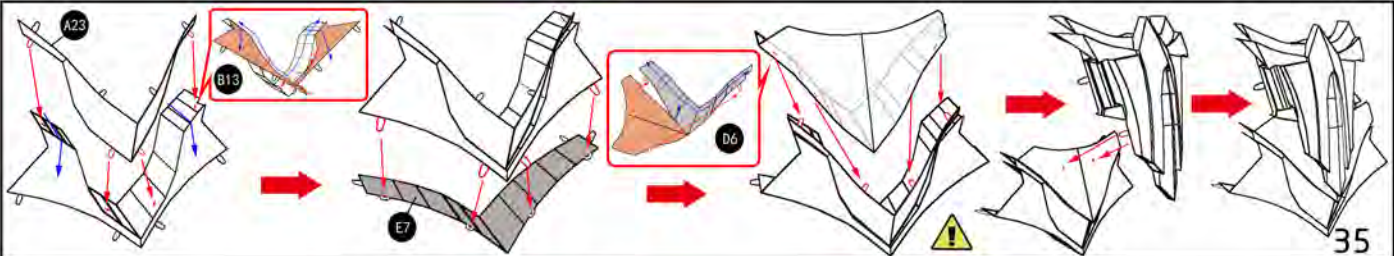
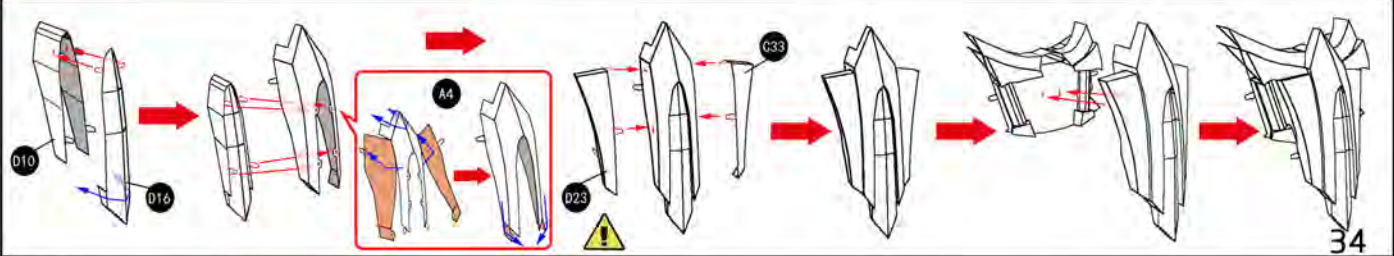
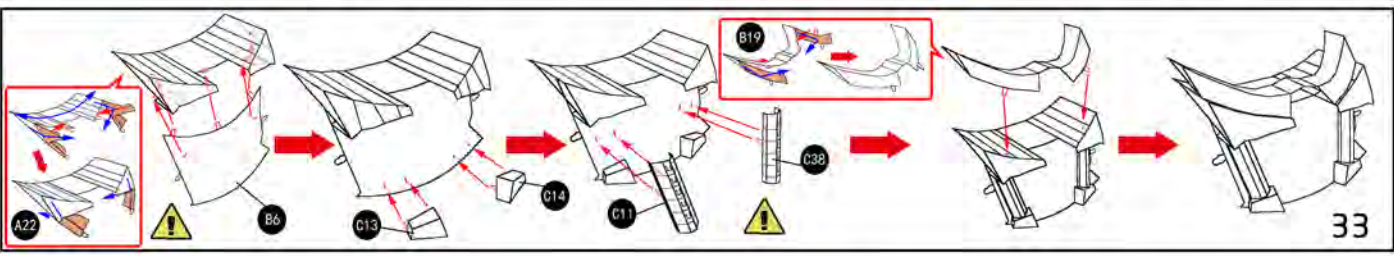
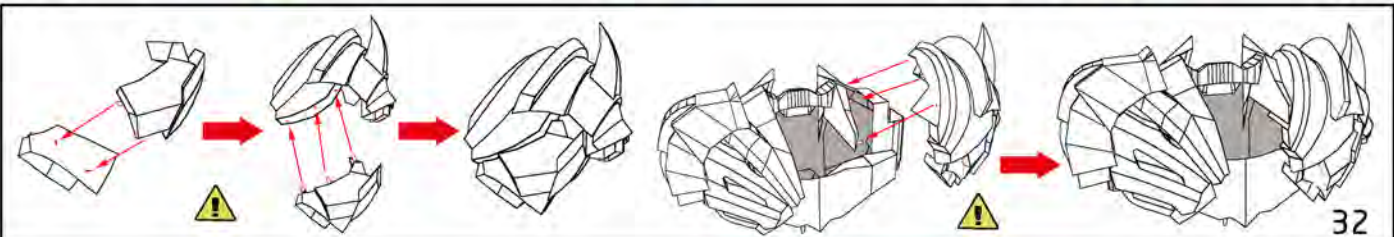
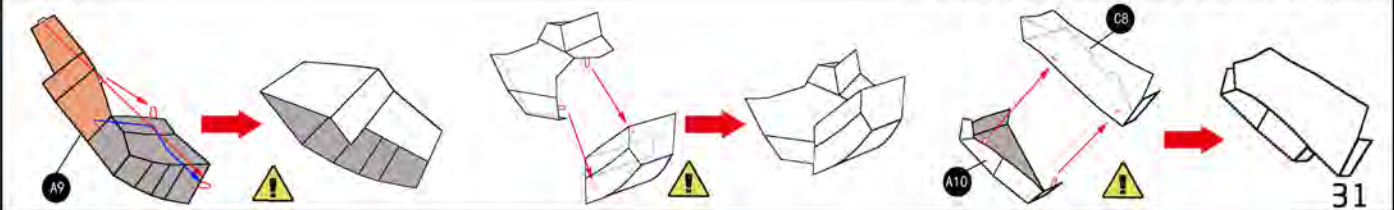

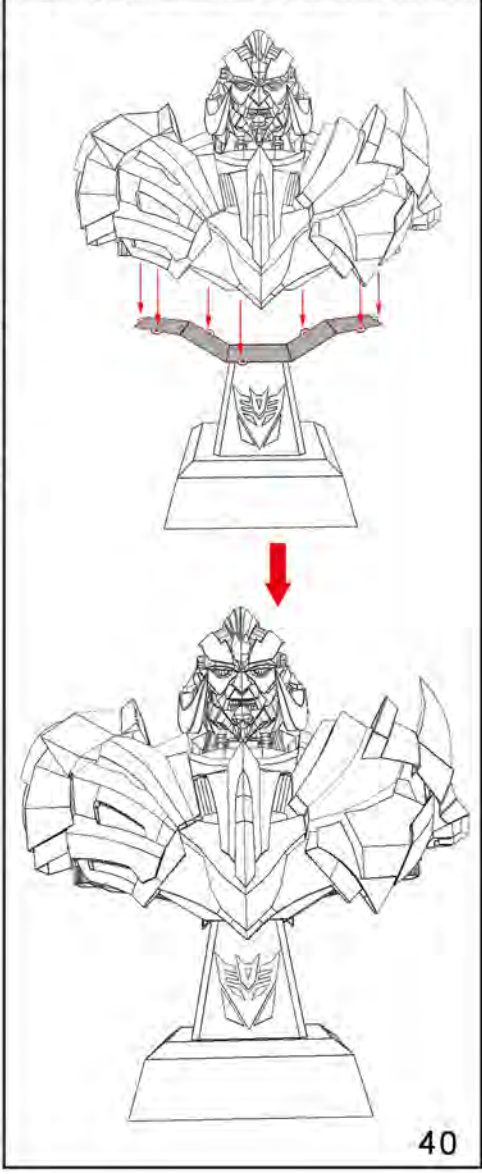
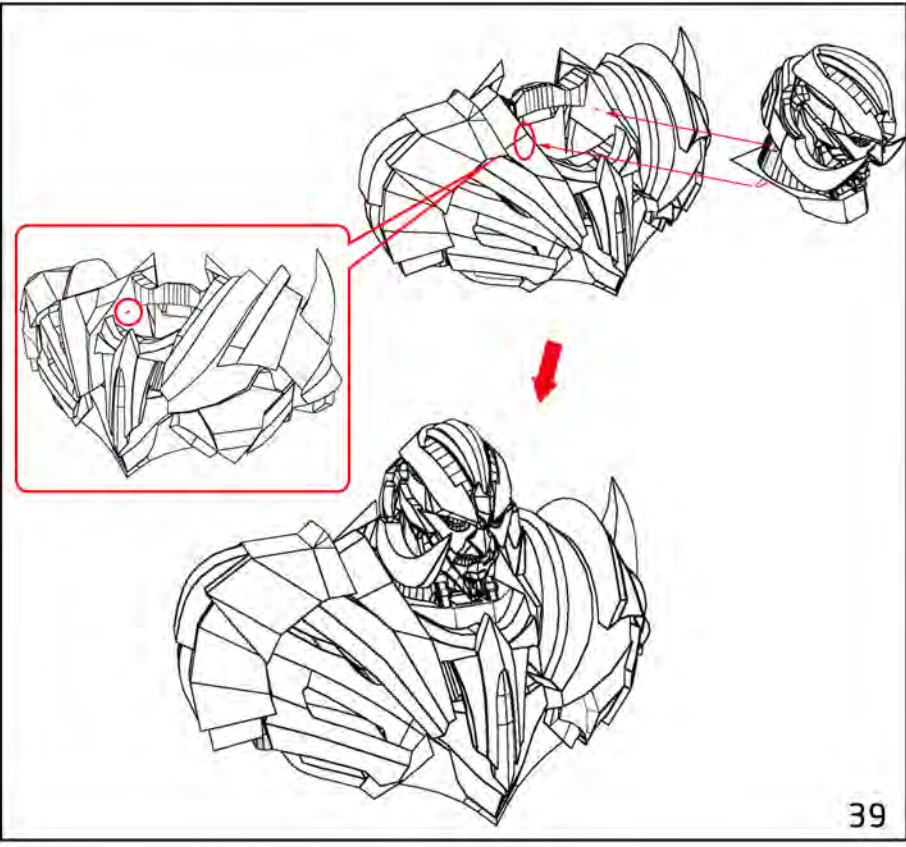
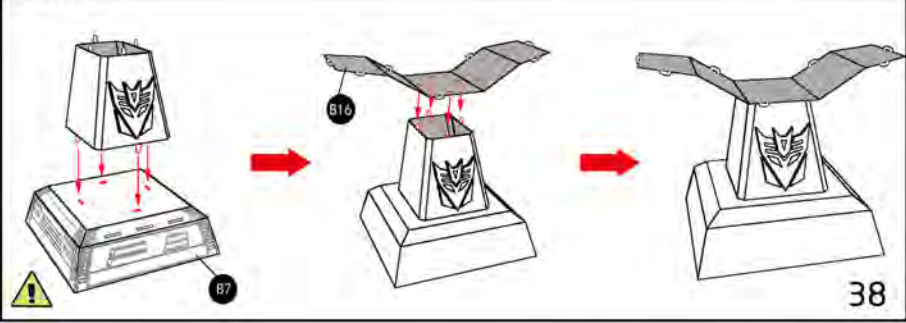

MU 艺模
 MU art model

Design by: Remember
 因幡Tewi
 羽焰

扫码加入微信公众号 解锁更多模型
 Scan the two-dimensional code
 to join us and unlock more models.

上海艺模电子科技有限公司
 Shanghai Art Model Electronic
 Science and Technology Co., Ltd. **关注我们**
 focus on us

